

Silicon Etalon 8mm x 8mm

REVISIONS			
REV	REVISED PER	Date	Approved
A	first release	2010 May 7	JHH
B	CN 2132	March 29, 2012	JHH
C	CN 2706	June 17, 2014	JHH

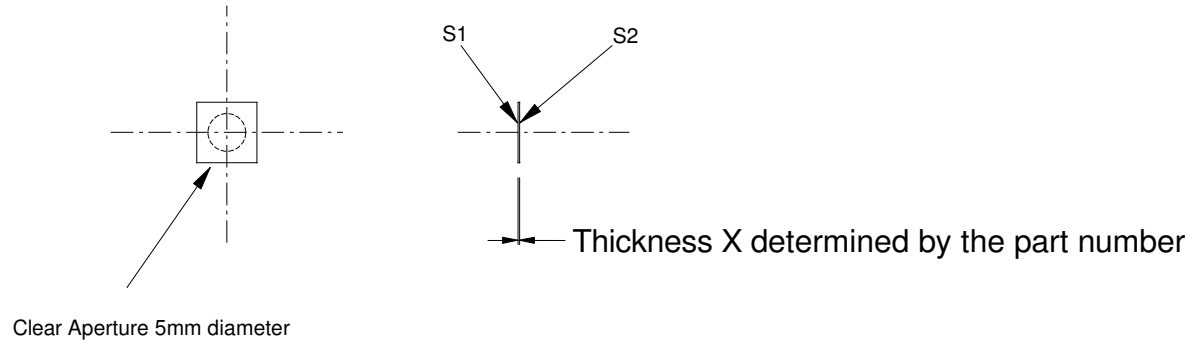

Thickness, A	Tolerance
X	the greater of $\pm 1\%$ of thickness or $\pm 0.002\text{mm}$

Notes:

1. thickness uniformity $\lambda/50$ over CA
2. S1 and S2, scratch dig 10-5
3. Single crystal silicon.
4. Uncoated.

LightMachinery OP-3852-x	
dimensions mm	material Silicon
Scale 1:1	
Tolerances (unless otherwise noted) X ± 0.5 A $\pm 1^\circ$ X.X ± 0.1 A.A $\pm 0.1^\circ$ X.XX ± 0.025	
Drawing Template QT-730-002-C	Third angle projection
This design and print is the property of LightMachinery, Inc., and shall not be used as the basis for the manufacture or sale of apparatus without the written permission of LightMachinery, Inc.	

REVISIONS			
REV	REVISED PER	Date	Approved
A	first release	2006 Jun 21	IJM
B	CN 1260	Nov 20, 2006	JHH
C	CN 2129	March 29, 2012	JHH

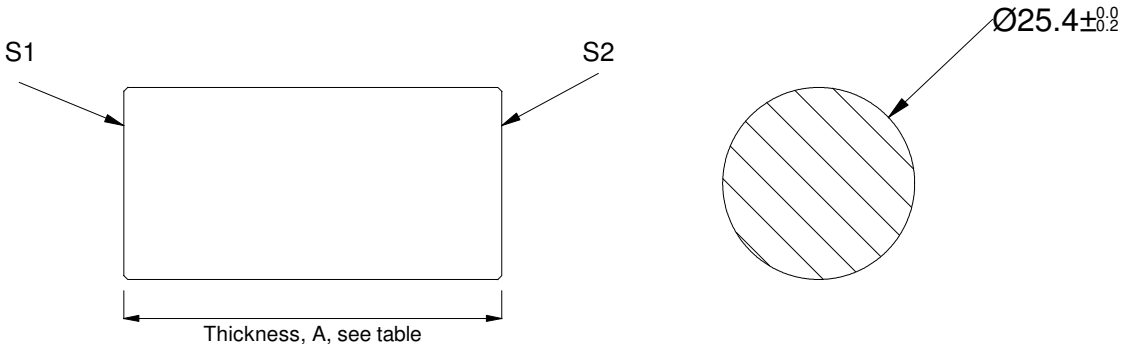

Part Number	Thickness, A	Tolerance
OP-2638-X	X	the greater of $\pm 1\%$ of thickness or $\pm 0.001\text{mm}$

Notes:

1. S1 and S2 flat to $\lambda/10$ at 633 nm, parallel within 1 arc second over the full aperture.
2. S1 and S2, scratch dig 40-20, barrel fine grind, edges chamfered approximately 0.7 mm face width.
3. Single crystal silicon.
4. Clear aperture 50% of the diameter (12.7mm).
5. Uncoated.



info@amstechnologies.com
www.amstechnologies-webshop.com



Silicon Etalon 25.4 mm
LightMachinery OP-2638-X

dimensions mm	material single crystal Si
Tolerances (unless otherwise noted) X ± 0.5 A $\pm 1^\circ$ X.X ± 0.1 A.A $\pm 0.1^\circ$ X.XX ± 0.025 Drawing Template QT-730-002-E	
Scale 1:1 Third angle projection	

This design and print is the property of LightMachinery, Inc., and shall not be used as the basis for the manufacture or sale of apparatus without the written permission of LightMachinery, Inc.