

LED LIGHT SOURCES ACCESSORIES

FIBER-COUPLED LED ACCESSORIES

Part Number	Description
ACC-FCS-C05	Cable for (1) FCS-series fiber-coupled LED light sources; (2) WLS-series WheelLED Wavelength-Switchable LED Sources; (3) FFC-series Fiber-Coupled LED Light Sources; and (4) GCS-series Lightguide Coupled LED Sources.
ACC-FCS-C05-BLS	Cable for FCS-, FFC-, GCS-, and WLS-series LED light sources. With push-pull connectors on both ends for connecting to BLS-controllers.
ACC-WFC4-C05	Cable for 4-channel WFC-series LED sources.
ACC-WFC4-C05-ADP	Adapter cable for converting bare wire connectors to push-pull connectors used for connecting to BLS-controller.
ACC-WFC4-C05-BLS	Cable for 4-channel WFC-light sources. With 4 push-pull connectors for connecting to BLS-controllers.
ACC-WFC4-C05-BLS-ADP	Adapter cable for converting push-pull connectors used for connecting to BLS-controller to bare wire connectors.

MULTIMODE FIBER PATCHCORDS

Part Number	Description
FPC-0200-22-02SMA	Multimode Fiber Patchcord, 0.22 NA, 200µm Core SMA Connectors, 2 meters in length
FPC-0200-37-02SMA	Multimode Fiber Patchcord, 0.37 NA, 200µm Core SMA Connectors, 2 meters in length
FPC-0300-37-02SMA	Multimode Fiber Patchcord, 0.37 NA, 300µm Core SMA Connectors, 2 meters in length
FPC-0400-22-02SMA	Multimode Fiber Patchcord, 0.22 NA, 400µm Core SMA Connectors, 2 meters in length
FPC-0400-37-02SMA	Multimode Fiber Patchcord, 0.37 NA, 400µm Core SMA Connectors, 2 meters in length
FPC-1000-22-02SMA	Multimode Fiber Patchcord, 0.22 NA, 1000µm Core SMA Connectors, 2 meters in length
FPC-1000-37-02SMA	Multimode Fiber Patchcord, 0.37 NA, 1000µm Core SMA Connectors, 2 meters in length
FPC-0400-22-01SMA-FC	Multimode Fiber Patchcord, 0.22NA, 400µm Core, SMA Connector one end, FC connector the other end, 1 meter in length
FPC-0200-22-02SMA-BP	Multimode Fiber Patchcord, 0.22 NA, 200 µm Core SMA Connector on one end, polished bare fiber on the other end, 2 meters in length
FPC-0200-37-02SMA-BP	Multimode Fiber Patchcord, 0.37 NA, 200 µm Core SMA Connector on one end, polished bare fiber on the other end, 2 meters in length
FPC-0400-22-02SMA-BP	Multimode Fiber Patchcord, 0.22 NA, 400 µm Core SMA Connector on one end, polished bare fiber on the other end, 2 meters in length
FPC-0400-37-02SMA-BP	Multimode Fiber Patchcord, 0.37 NA, 400 µm Core SMA Connector on one end, polished bare fiber on the other end, 2 meters in length

FURCATED FIBER BUNDLES

Part Number	Description
FFB-02-0105-22-00SMA	Furcated fiber bundle, 2x 0.22NA 105µm core fiber, 1 meter each, total length 2 meters, SMA connectors.
FFB-02-0200-22-00SMA	Furcated fiber bundle, 2x 0.22NA 200µm core fiber, 0.5 meter each, SMA connectors.
FFB-03-0400-22-00SMA-1Q	Furcated fiber bundle, 3x 0.22NA 400µm core fiber, 0.5 meter each leg, 1.5 meter total length, SMA connectors on split ends, 1/4" stainless steel ferrule on common end.

CONNECTING PLATES FOR BEAM COMBINERS

Connecting Plate 1 |

ACC-BC25-CP-01



Connecting Plate 2 |

ACC-BC25-CP-02



Connecting Plate 3 |

ACC-BC25-CP-03

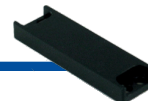

PUSH-PULL ADJUSTABLE MOUNT FOR BEAM COMBINERS

Push-Pull Adjustable Mount |

ACC-LCS-BC25-PPM



MICROSCOPE ADAPTERS

MODELS

Adapter for Leica DMI microscope |

ACC-BC25-LC1

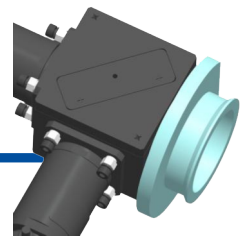

Adapter for Nikon Eclipse microscope |

ACC-BC25-NK1

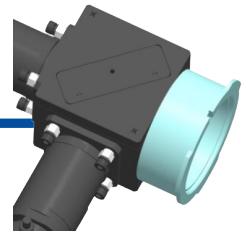

Adapters for Olympus IX & BX microscopes |

ACC-BC25-OL1 | Adapter to connect LCS-BC25

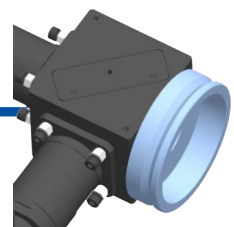

Adapter for Olympus MLS products |

ACC-BC25-OL2



Adapter for Zeiss Axioskop microscope |

ACC-BC25-NK1

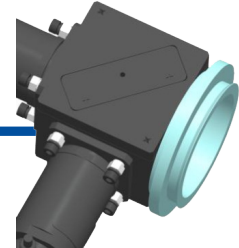

Adapter for transmission port of Nikon Eclipse & Nikon LV-UEPI/2/A illuminators |

ACC-BC25-NK-LV-UEPI



COLLIMATED LED FOCUSING MODULES

Part Number	Description
ACC-LCS-F-11	Focusing Module for 11mm-clear-aperture LED Collimator Sources, Working Distance ~5mm.
ACC-LCS-F-22	Focusing Module for 22mm-clear-aperture LED Collimator Sources, Working Distance ~10mm.
ACC-LCS-F-22-50	Focusing Module for 22mm-clear-aperture LED Collimator Sources, Working Distance ~50mm.
ACC-LCS-F-22-100	Focusing Module for 22mm-clear-aperture LED Collimator Sources, Working Distance ~100mm.
ACC-LCS-F-38	Focusing Module for 38mm-clear-aperture LED Collimator Sources, Working Distance ~20mm.
ACC-LCS-F-48	Focusing Module for 48mm-clear-aperture LED Collimator Sources, Working Distance ~30mm.

INTERCHANGEABLE COLLIMATING LENSES

Part Number	Description
ACC-LCS-C-11	Additional interchangeable collimating lens with barrel, clear aperture 11mm.
ACC-LCS-C-11-B	Additional interchangeable collimating lens with barrel, clear aperture 11mm, for type-B light sources.
ACC-LCS-C-22	Additional interchangeable collimating lens with barrel, clear aperture 22mm.
ACC-LCS-C-22-B	Additional interchangeable collimating lens with barrel, clear aperture 22mm, for type-B light sources.
ACC-LCS-C-38	Additional interchangeable collimating lens with barrel, clear aperture 38mm.
ACC-LCS-C-38-B	Additional interchangeable collimating lens with barrel, clear aperture 38mm, for type-B light sources.
ACC-LCS-C-48	Additional interchangeable collimating lens with barrel, clear aperture 48mm.
ACC-LCS-C-48-B	Additional interchangeable collimating lens with barrel, clear aperture 48mm, for type-B light sources.

EMPTY FILTER/OPTICS HOLDER FOR LCS SOURCES

Part Number	Description
ACC-LCS-H-22	Empty filter/optics holder for 22mm-clear-aperture LED Collimator Sources, accepts 1" and 25mm-diameter filters or optics with thickness of 5mm or less.

COLLIMATED LED CONNECTOR TUBES

Part Number	Description
ACC-LCS-CMM	Male to Male C-Mount connector with inner threads.
ACC-LCS-CFF	Female to Female C-Mount connector with outer threads.
ACC-LCS-22-T15	15mm extension tube for 22-mm clear-aperture LCS light sources.

LIGHTGUIDE COLLIMATORS

Key Features

Lightguide collimators are used to either couple light from free space into a lightguide or collimate light from a lightguide to form a collimated (parallel) optical beam. Lightguide collimators are key components with numerous applications. For example, a lightguide collimator can project light from a lightguide into a uniform spot in free space.

Aspherical lens
Adjustable focus with locking ring
Accepts various ferrule diameters

High-numerical-aperture aspherical lenses are used for precise collimation and maximum light throughput. The collimator features adjustable focus from 100mm to infinity. Various lightguide ferrule diameters are supported. Customization is available for other ferrule diameters.

The full field of view (FOV) or full divergence angle can be calculated as $FOV = 2 \arctan(D/2f)$, where D is the lightguide core diameter and f is the focal length of the lens. Alternatively, the linear field of view on an object placed at a distance L away from the collimator is $D(L/f)$.

MODELS

Lightguide Collimators |

LGC-019-022-05-V
LGC-019-022-07-V
LGC-019-022-11-V
LGC-019-022-1Q-V



PERFORMANCE SPECIFICATIONS

Part Number	Focal Length mm	Clear Aperture mm	F# / NA	Lens Material	Wavelength Range nm	Lightguide Ferrule, OD1
LGC-019-022-05-V	19	22	0.86 / 0.5	B270	350 ~ 2,000	5mm
LGC-019-022-07-V	19	22	0.86 / 0.5	B270	350 ~ 2,000	7mm
LGC-019-022-11-V	19	22	0.86 / 0.5	B270	350 ~ 2,000	11mm
LGC-019-022-1Q-V	19	22	0.86 / 0.5	B270	350 ~ 2,000	6.35mm



info@amstechnologies.com
 www.amstechnologies-webshop.com

Contact us 